

The Folding Sliding Door Company

Fitting Instructions

These instructions are a guide for all configurations of systems in timber, aluminium, aliclاد and upvc.

Before you begin make sure that your opening is at least 10mm bigger than your door size, all sides are level and all sides are of a material that will allow you to gain a firm fixing.

Always remove the glass before installing your door.

The recommended tools you require for installing your door are: a rubber mallet, hammer, scraper, drill, cutters, screwdrivers, tape measure, staple gun, chisels, spirit level and a hacksaw.

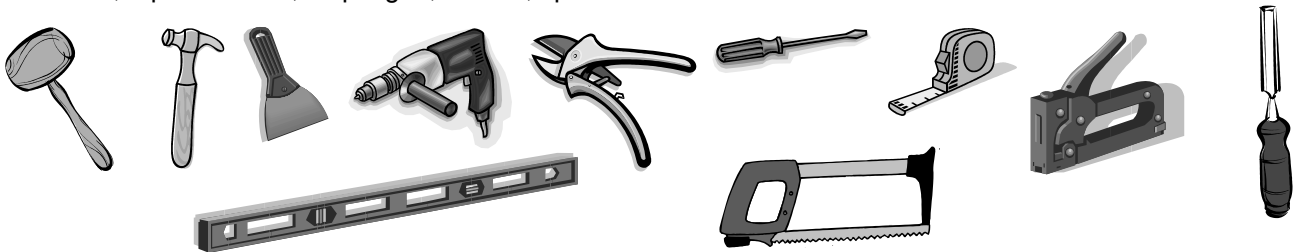

Instructions

If you have purchased an untreated timber folding sliding door the first thing to do before commencing with any installation is to fully apply the finish.



1. Lightly sand the timber with a fine sand paper.
2. Apply a base coat to stain and protect the timber.
3. Lightly sand the basecoat to remove any rough areas but not to remove the basecoat.
4. Using a good synthetic brush, apply a coat of micro porous finish as a mid coat to seal the timber.
5. Lightly sand the mid coat to remove any rough areas but not to remove the mid coat.
6. Using a good synthetic brush, apply a coat of micro porous finish as a top coat to finish the timber.
7. Attach all gaskets as shown in the diagram.

Rubber gaskets are easily pushed into the grooves.

Peel the back from the glass gasket and adhere to the glass beads and glazing rebates (timber only).

Fit the brush seal carrier into the bottom of each panel and sliding post. Cut flush to the edge. Slide in the brush seal allowing it to hang 30mm over the carrier, cut the center flipper in line with the end of the carrier and slide the brush into the rubber gasket. Staple through the center of the brush flipper.

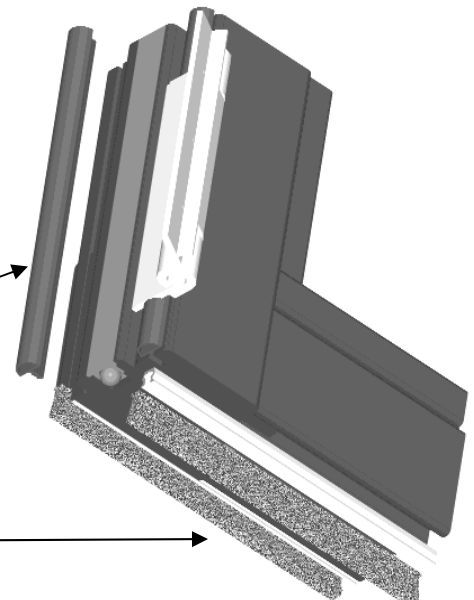

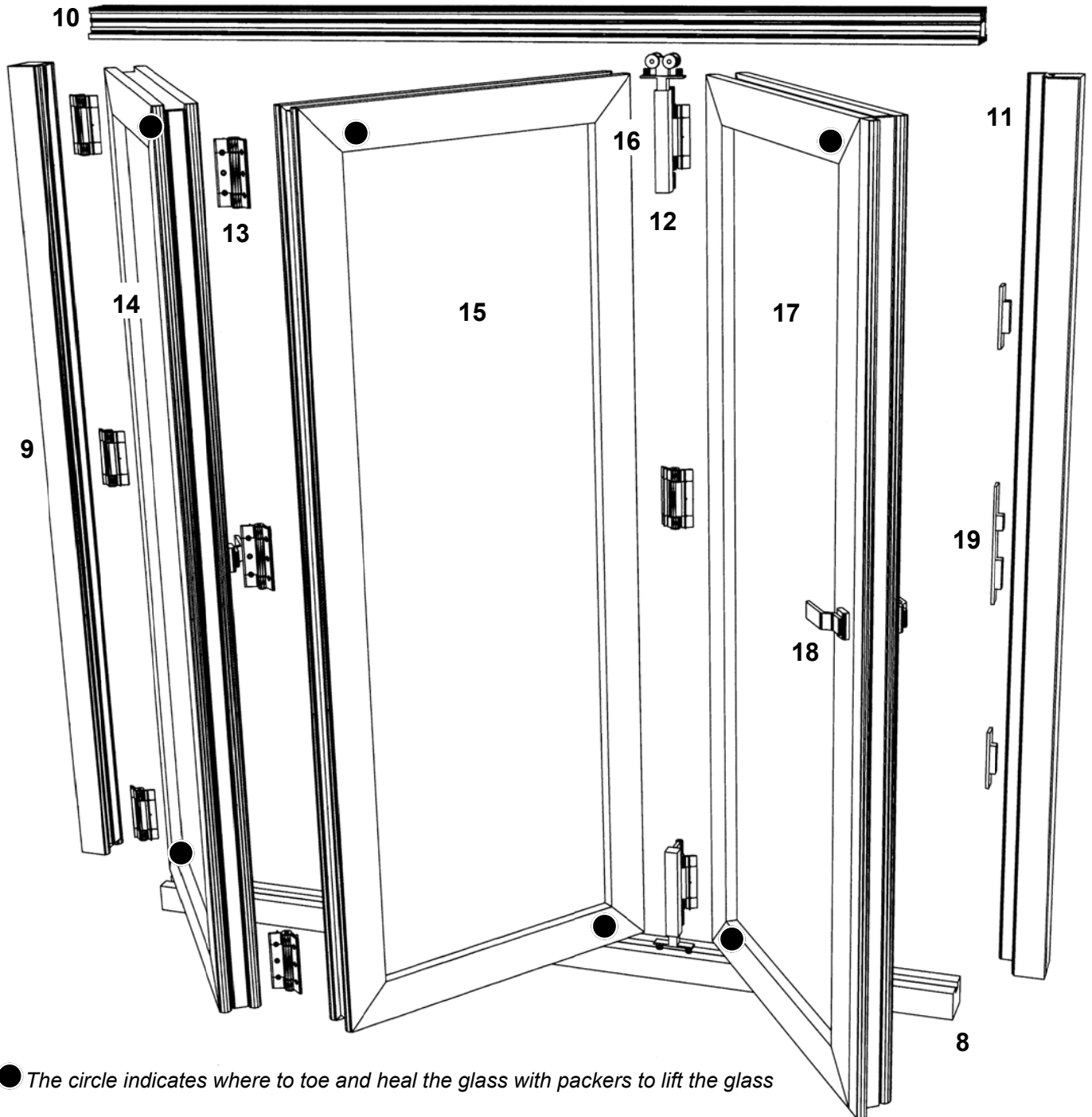

● The circle indicates where to toe and heel the glass with packers to lift the glass

8. Fix the bottom track level. The bottom track determines the position of the door.

9. Fix the first jamb level and make sure it is sat firmly onto the bottom track. Fixings should be set behind the tongue infill.

10. Fix the top track. To help level the top track use the second jamb as a staff and pack the track tightly onto it. Fix the top track every 500mm. Ensure the roller port is on the stacking side.

11. Fix the second jamb level and make sure it is sat firmly onto the bottom track and tightly under the top track.

12. Slide the running gear or post(s) onto the tracks.

13. Fit the top and bottom hinges 70mm from the top and bottom of the panels & post and 78mm from the top and bottom of the jambs. The center hinge is set 700mm from the top.

14. The first panel to fit is on the stacking side, it has two point locking and a flat handle on the inside.

15. The second panel connects to the first. The second panel is blank, no locking and no handles.

16. Connect the running gear or post.

To fit more bi-fold sections i.e. 4 panels stacking one side, repeat 14, 15 and 16

17. A swing or access panel can connect to either a bi-fold or the second jamb.

18. Fit handles and cylinders. The square key bar has a sleeve over it, this sleeve must be situated in the lock.

19. Once the door is closed, open the swing panel slightly and mark the closing edge with the position of the keeps. Fit the keeps. You may have to alter the keep position to enable the panel to lock.

20. Set the packers for the glass as shown above. A packer must be placed on the bottom rail in the ● position.

21. Insert the glass and pack the top in the ● position. Place packers on all four side corners of the glass.

22. Fix glazing bead. You may use panel pins, but a nail gun with 30mm pins is advisable (timber).



These examples will help to determine where all parts are fitted to other configurations



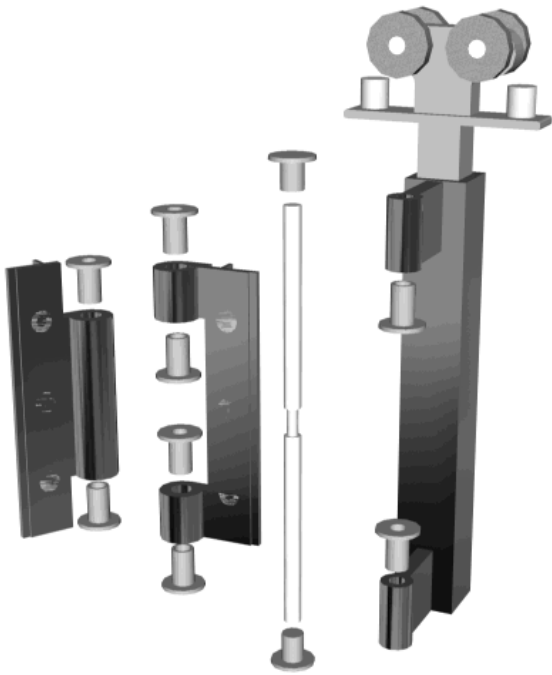

Aluminium roller assembly

This roller once assembled and fitted has three grub screws. The grub screw on the hinge is to lock the hinge in position and maintains high security, without it, the hinge is vulnerable to crime.

The grub screws on the roller carrier are to lock the roller into position after adjustment.

Adjust the roller by moving the inner part up and down. Tighten the grub screws.

Once the door has been adjusted to your satisfaction, take out the top grub screw and using a 3mm drill, drill a small hole in the inner part of the roller. Replace the grub screw.



Aluminium hinge assembly

This hinge is to be split into two leaves. One leaf is fixed to one door component and the other is fixed to the connecting component.

When connecting two components, insert the bushes in the hinge leaves and slide the two leaves of the hinge together.

Insert the hinge pin so that the groove in the center of the pin is in the center of the hinge.

Tighten the grub screw. The grub screw on the hinge is to lock the hinge in position and maintains high security, without it the hinge is vulnerable to crime.

Insert the hinge caps. A dab of glue may be advisable.

Note: The stainless steel running gear on a timber door is adjusted by turning the adjuster on the end of the roller

Trouble Shooting

Door is dragging on the bottom.	The panels may need toe and healing with more packers. The bottom track is not level or flat.
Door is dragging on the top.	The panels may be over toe and healed, remove packers. The top track is not level or flat.
Door is dragging on the top and bottom.	The tracks are not level or flat. The opening is too small for the door.
The panels at each side are not connecting when the door is closed.	Fix packers behind the jambs to bring the jambs in.
The panels at each side are catching when the door is closed.	Remove packers from behind the jambs. The opening is too small for the door.
There are gaps at to top and/or the bottom.	The tracks are not level or flat. The tracks are not parallel and sat on top of the jambs. The brush seals have not been fit to the panels or top track.

If you have any problems or queries, please do not hesitate to call our technical department on 0845 644 6630